

A- Arc-shaped reflector board
 B- Reflector board with opening
 C- Straight reflector board

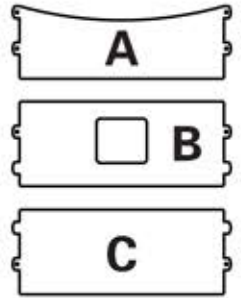

MINI ASSEMBLING INSTRUCTIONS



1. Place the studio (rivets up) on a table near a power outlet.



2. Pull the four velcro on the sides of the studio.



3. Open the studio and take out the spare fluorescent tubes for future use.



4. Insert the metal part of the tubes into the opening of the bracket and twist 90 degree.



5. Hold the studio with your right hand and turn up board A into position on the left side to support the top lid. Be careful not to hit the fluorescent tubes. Repeat procedure on the right side with board B.



6. Pull out the power cord through the gap in the bottom corner of board R.



7. Please pay attention to the difference of the arc angle of L and R as well as the positioning of the power supply wire.



8. Take out reflectors A, B and C.



9. Pull out the background and align it to the bottom front edge of the studio.



10. Place reflector board A into the studio by first inserting the tenons on the left side into the slot holes of board L.



11. Bend reflector A and insert the right-side tenons into the slot holes of board R.



12. From the inside, bend reflector A into position, the studio is now completely assembled.



13. Plug in the power cord and turn on the studio. Put the object into the studio, look for a perfect position and shoot.



14. When taking pictures, adjust the front and rear positions by using a tripod, you can take clearer photos efficiently and also avoid hand shaking.



15. For low angle shooting, assemble reflector B to the bottom position (as shown in the figure). Insert the bottom tenons of reflector A and the top ones of reflector C into the same slot holes.



16. For middle angle shooting, assemble reflector B to the middle position (as shown in the figure). Insert the bottom tenons of reflector A and the top ones of reflector B into the same slot holes.



17. For high angle shooting, assemble reflector B to the top position (as shown in the figure). Insert the bottom tenons of reflector B and the top ones of reflector A into the same slot holes.

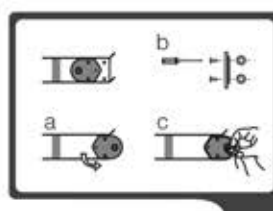

How to install the strap:
 a. Turn 180 degree
 b. Tighten the screws
 c. Lock the strap on to both sides of the ears.



WITH **Simp-Q Photo Studio** NO PHOTOGRAPHY SKILLS IS REQUIRED
JUST NEED TO REMEMBER **2** THINGS

We assure that you can get a better photos with **Simp-Q**

1 SHOOT THE PRODUCT IN BIGGER SIZE

Don't waste your camera's pixel. This will help in getting a better quality picture in developing photo, catalogue and poster.



2 Exposure composite in camera is a very useful function. By adjusting ± 0 or EV. It controls the brightness of photo. It is a secret to most of the photographers.

WHITE PLUS(+)
BLACK MINUS(-)

When using a **white** background, set the exposure between +0.7 to +1.0 or more
When using a **black** background, set the exposure between -0.3 to -0.7 or more

Using **P** mode in **Simp-Q Photo Studio**

PRIMARY GUIDELINE

- Set the White Balance (WB)** to "Auto" or "Daylight".
- Turn off the flash.** In **Simp-Q** photo studio, flash is not needed.
- When taking close-up shots, **set the camera to "macro" mode.**
- Use a tripod** a slight vibration will cause the image blurred.

If you are not familiar with the camera settings mentioned above, please search more about it, online according to your camera brand or get in touch with the after sales service hotline of the camera for more information.

You can use various of material to set up your **Simp-Q** background. You can create a background to suite your product theme.



Taking pictures of transparent or glossy product

Hold a piece of newspaper, touch the object and press the shuttle button focus on the paper, once focus, pull out the paper, then snap the photo.



It is also a pantone color matching tool.

Apart from taking photos, advertisement companies, toy, clothing and woolen cap manufacturers, etc. Uses the **Simp-Q** for Pantone and CMYK color matching.



PS EDITING Whether you are professional or amateur, you need to edit with PS. (normally take about 1-2minute) **Caution: If photo taken is not good, photo editing will make the photo look worst.**

Open PS

→ Image → Adjustments

→ Auto Tone
Auto Contrast
Auto Color

Or

Image → Adjustments
Brightness / Contrast
(Adjust accordingly to your liking)

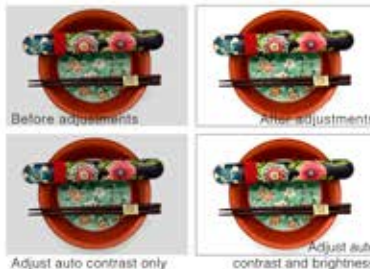

Sharpen

It is to make the image to be more sharp and clearer. Using Filter → Sharpen → Smart sharpen

Use · Keep · Cleaning



Place reflection A, B and C crosswise under the background. (Place the Arc-shaped reflection board inward)



Push the background forwards into place.



Hold the top of the studio with your left hand and turn down board R with your right hand.



Then turn down board L and place the power cord at the rear as shown in the figure.



Lock the buckles on the front of the studio.



Fasten the velcro on the side of the studio tightly.

Change background

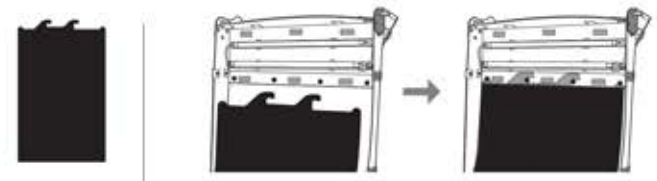

Setting handing rod

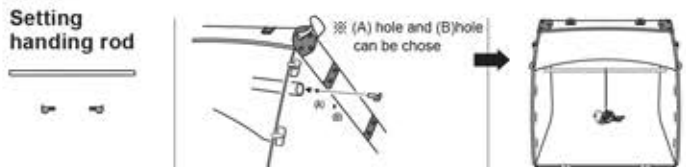

Diffuser is only applied when shooting glossy items.

Setting diffusion sheet

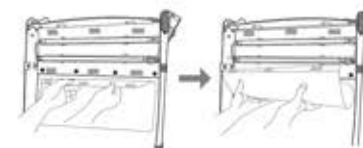

Before using diffusion sheet



TIPS
Use a few mirrors from different angles to reflect the objects to highlight it.



Cleaning tips

If background or reflection boards get dirty, use a wet sponge and dish washer, then dry it with a cloth.



Made complexity become simple & Simplicity to the perfection